



SS - / 60 / 60M

FIRE AND ACOUSTIC RATED SINGLE METAL STUD PARTITION WALL SYSTEM

Multiboard is ideally suited to fire walls and acoustically rated partitions. Single layer applications can achieve an FRL of over 90 mins and acoustic ratings $R_w + C_{tr}$ of over 50db.

The following construction detail and its performance is one example of a Multiboard Fire and Acoustic Wall System: Please use the specification detail in this brochure in conjunction with the iLINE installation manual and internal applied finishes specification.

All literature is available on request or can be downloaded from the Multiboard website www.multiboard.com.au

Fire and Acoustic Specification Single Metal Stud

Wall Type	Load Bearing Capacity	Fire Resistance Level	Lining Requirements	Insulation	R_w	$R_w + C_{tr}$	Wall Thickness	Framing Size	Weight of Boards
Single Stud	N/A	-/60/60	1 layer of 15mm Multiboard iLINE each side	50mm 10kg/m ³ glasswool	51	41	106mm	76 by 35 stud and 76 by 35 top and bottom plates	14.7kg/m ²

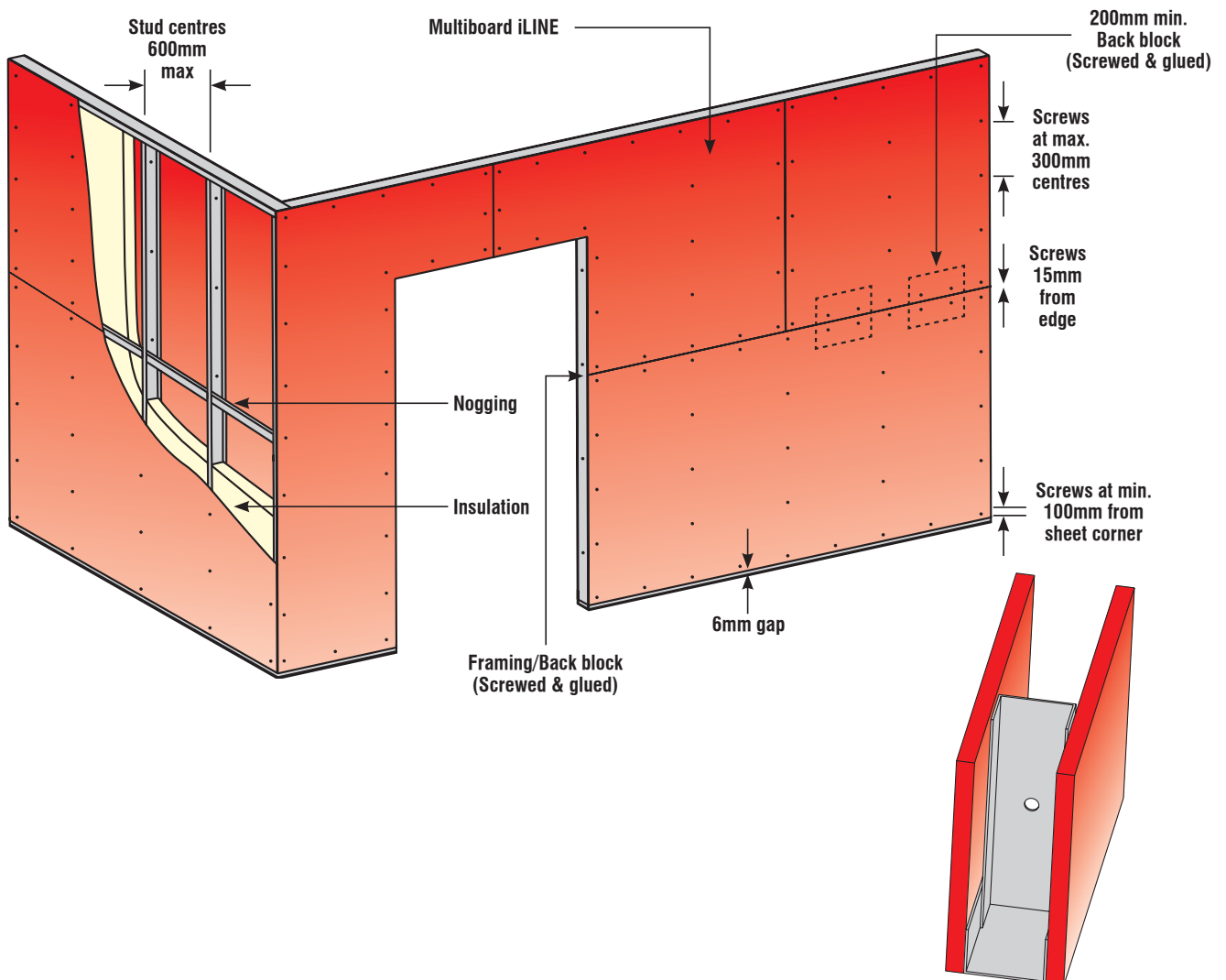

Framing and Wall Height

76mm x 35mm rondo stud. Stud spacing at 600mm maximum.

Non-loadbearing partitions framing dimensions and height as determined by AS3623-1993 Domestic Steel Framing.

Lining (Refer iLINE Installation Manual)

Apply one layer of 15mm thick Multiboard iLINE to each side of the single stud wall.

Both vertical fixing and horizontal fixing is recommended. In vertical applications offset joints between sheets by 300mm on opposite sides of the frame.

Sheet joints must be formed over framing or back blocked (screwed and glued). Back blocks are recommended to be a minimum 200mm wide and 400mm wide for but joints.

A 6mm gap should be left between the Multiboard and the floor. All gaps must be sealed with a fire and / or acoustic rated sealant aligned to the wall rating.

Fasteners

30mm x 8g countersinking screws, at 300mm centres for the Multiboard.

Jointing

All fastener heads stopped and all sheet joints tape reinforced and stopped using wet area base coat in accordance with our standard procedures of iLINE. Self-adhesive tape or mesh tape is not to be used in stopping the joints. Refer to manufacturers recommended instructions to stopping and finishing of iLINE.

Insulation

Sound control insulation shall be a minimum of 100mm 10kg/m³ glasswool installed between the studs.

WARRANTY

iLINE (Multiboard) warrants for a period of seven (7) years ("the warranty period") from the date of purchase that all iLINE products ("the product") will be free from defects due to faulty manufacture or materials, and will be resistant to cracking, rotting, fire and damage to the extent set out in Multiboard's published literature current at the time of installation, and strictly subject to the conditions set out below. Nothing in this document shall exclude or modify any legal rights of any person under the Trade Practices Act or otherwise which cannot be excluded or modified at law.

Conditions of Warranty:

The Warranty is strictly subject to the following conditions:-

1. The product, and any other products including fasteners and joining systems, applied to or used in conjunction with the product must be used and installed strictly in accordance with the recommended installation methods at the time of installation.

2. Under no circumstances will Multiboard be liable for defects arising from:-

- (a) A failure to use and/or install the product, or any products, strictly in accordance with the product manual.
- (b) Defective materials not supplied by Multiboard; or
- (c) Impact.

3. Multiboard will not be liable for breach of Warranty, and no breach of Warranty claim will be accepted, unless the Claimant makes a written claim and provides proof of purchase within 30 days of the alleged defect becoming apparent.

4. This Warranty is not transferable under any circumstances without the prior written consent of Multiboard.

5. A Claimant's sole remedy for breach of Warranty is (at Multiboard's option) that Multiboard will either replace or repair the defect, supply replacement product, or pay for the cost of replacement or rectification of the affected product.

6. Under no circumstances shall Multiboard be liable for any consequential loss, property damage or personal injury, economic loss or loss of profits, arising in Contract or negligence or howsoever arising. Without limiting the foregoing, Multiboard will not be liable for any claims, damages or defects arising from or in any way attributable to poor or defective workmanship, defective materials or poor design or detailing, settlement or structural movement and/or movement or materials to which the product is attached, incorrect design of the structure, acts of God including but not limited to earthquakes, cyclones, floods or other severe weather conditions or unusual climatic conditions, normal wear and tear, or growth of any organism on any product surface.

7. The express warranties set out above are in lieu of all other representations, warranties or conditions, express or implied including but not limited to implied warranties or conditions of merchantable quality and fitness for a particular purpose, and those arising by statute or otherwise in law or from a course of dealing or use of trade and which are excluded to the fullest extent permitted by law.